

Order and Quote Form

Made-to-Length Linear Drainage



Select Grate Style



PS Punched Slot



MND Marc Newson



PAS Punched Angle Slot



PPS Punched Perpendicular Slot

Tray Profiles

100 Range

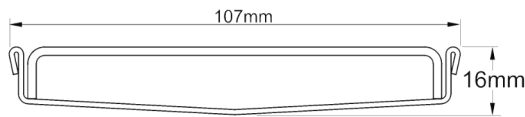

Profile

Specify Size, Outlet and Profile Required

Drain 1

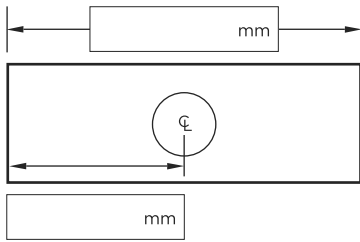

Outlet Size

- 38mm 44mm 51mm
 63mm 76mm 89mm

Drain 2

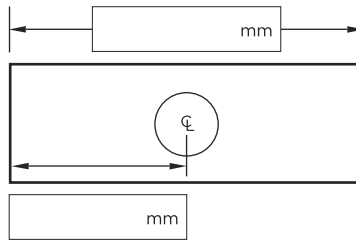

Outlet Size

- 38mm 44mm 51mm
 63mm 76mm 89mm

Drain 3

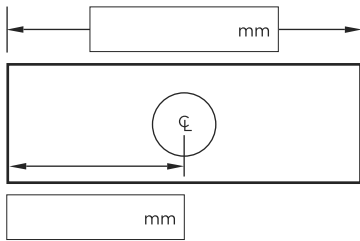

Outlet Size

- 38mm 44mm 51mm
 63mm 76mm 89mm

Please Note

See AS3500 standard & local regulator for specific outlet/drain requirements. Outlet Size must be smaller than selected Range. Stainless Steel Grade is 316 unless specified. Made-to-Length (MTL) minimum charge of 800mm. Grates longer than 1500mm are supplied in multiple sections. Channels are a maximum 3000mm in one piece, channels over 3000mm are supplied in multiple sections with joiner. Orders received after 11am are processed as next working day. +/- 2mm tolerance on dimensions.

Full Name

Company Name

Telephone

Email Address

Order Number

Stormtech Quote Number

Signature